

006-33C

Section 9
T36N R56E

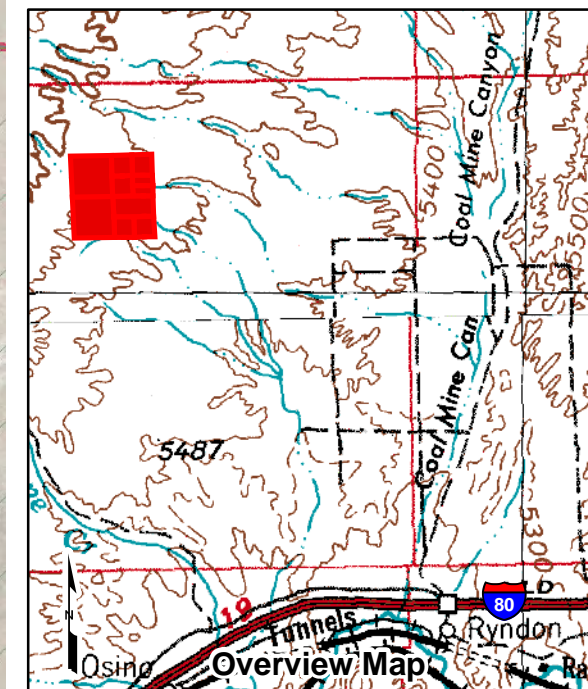

006-330

006-330

006-33B

6
160.00 Ac

2
40.00 Ac

1
40.00 Ac

4
20.00 Ac

3
40.00 Ac

5
20.00 Ac

006-330

006-330

7
160.00 Ac

10
80.00 Ac

8
40.00 Ac

9
40.00 Ac

006-330

006-330

006-330

Legend

- Subject Parcel
- Parcel
- Public Land
- Section Line

Reference Documents:
Map

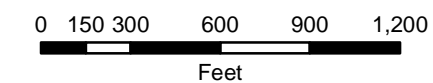

For assessment use only, does not represent a survey, no liability for accuracy is assured. Other uses forbidden unless approved by Elko County Assessor.

Raster Image - 2017 NAIP Flyover
Last Update: 09/25/2018

