

# 001-750 City of Elko

Portion of the E 1/2 Section 14  
T34N R55E, M.D.B. & M.

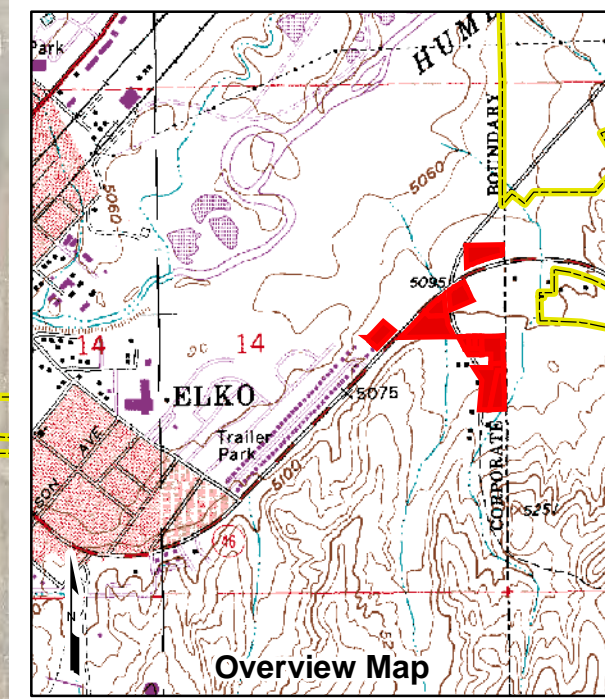

## Legend

- Subject Parcel
- Parcel
- Lot
- Easement Line
- Elko City Limit
- Section Line

Reference Documents:  
Parcel Map# 96607, 285188, 759989, 761498

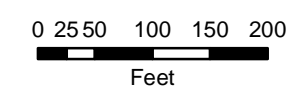

For assessment use only, does not represent a survey, no liability for accuracy is assured. Other uses forbidden unless approved by Elko County Assessor.

Raster Images - DRG downloaded from Keck Library  
Orthophoto - 2018 Pictometry Flyover

Last Update: 11/08/2019

