

CITY OF ELKO
 in
 Sections 15 & 16, T.34N., R.55E., M.D.B. & M.

001-070

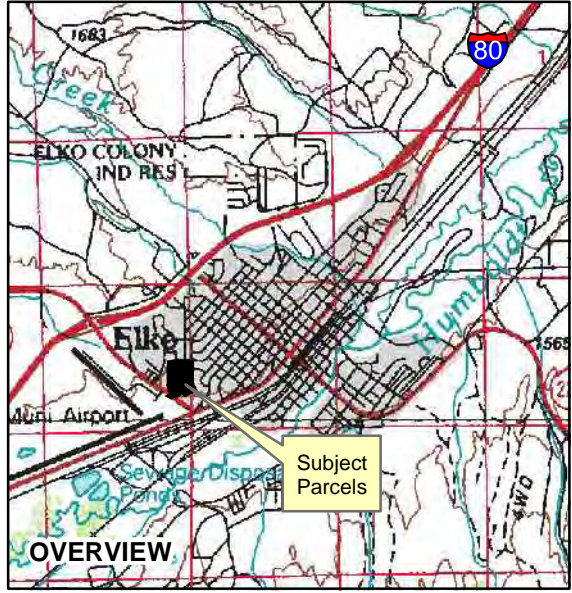
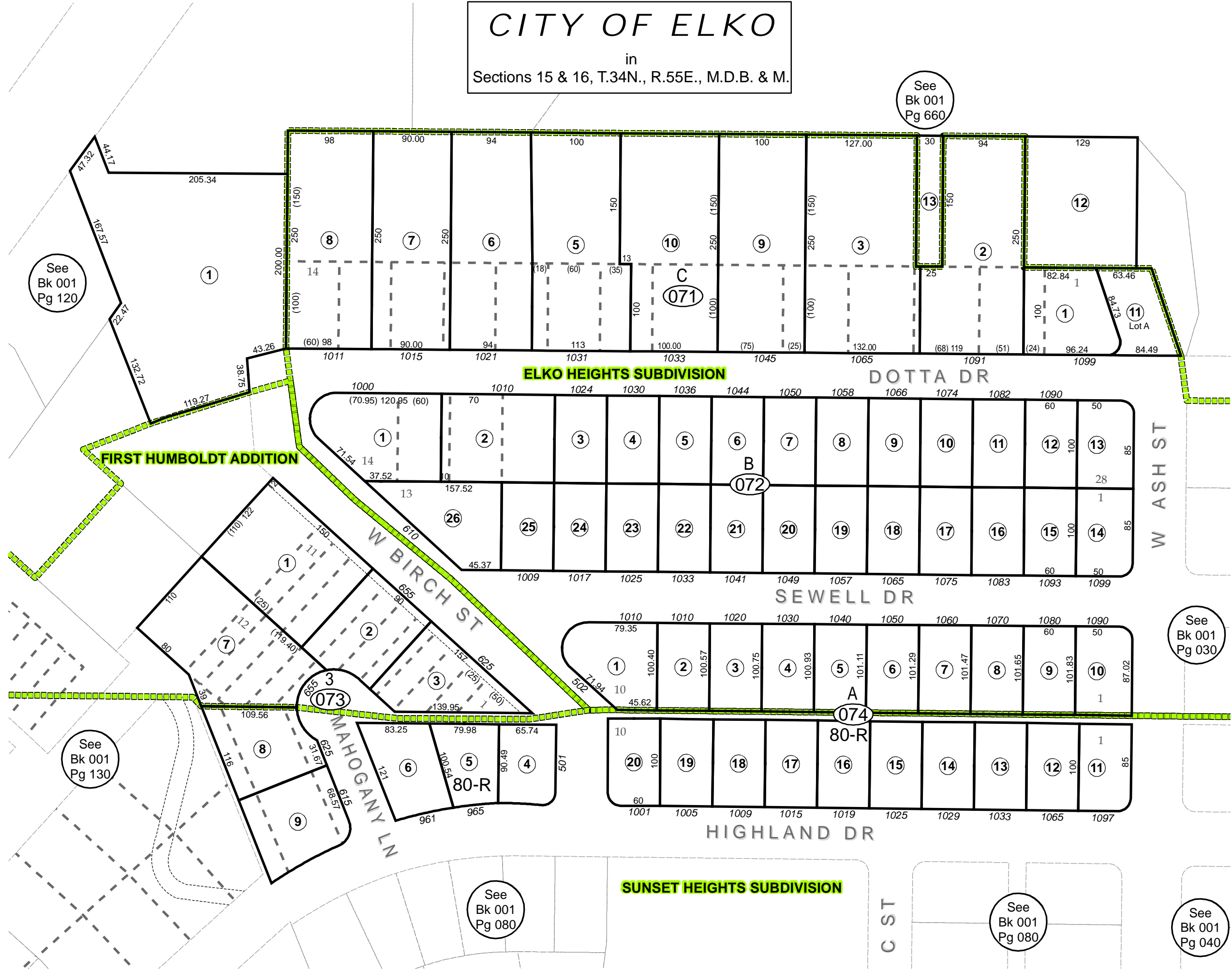

Legend

- Subject Parcel
- Parcel
- Subdivision Line
- Lot
- Easement_Line

N

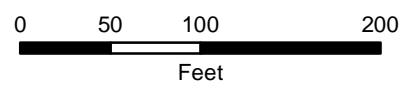

Reference Documents:
 ROS/BLA # 628052, 659021
 Parcel Map # 119681

This map does NOT represent a survey. It is compiled from official records, including surveys and deeds. Recorded documents should be used for detailed legal information. Unless approved by Elko County Assessor, other uses are forbidden.

See Bk 001 Pg 120

See Bk 001 Pg 660

See Bk 001 Pg 030

See Bk 001 Pg 130

See Bk 001 Pg 080

See Bk 001 Pg 080

See Bk 001 Pg 040